

257.83 (b) (2)	REPORT OF ANNUAL INSPECTION OF CCR SURFACE IMPOUNDMENT		
	FACILITY NAME: Plant McIntosh AP-1, Cell A		
	OWNER/OPERATOR OF FACILITY: Georgia Power Company		
	INSPECTION DATE: October 22, 2015		
	INSPECTING ENGINEER: Joel L. Galt, P.E. (Georgia P.E. License #014090)		
	Based on the results of my inspection and review of the data provided, it is my professional opinion that the report has been completed in accordance with 40 CFR 257.83(b).		
(i)	ANY CHANGES IN GEOMETRY OF THE IMPOUNDING STRUCTURE SINCE THE PREVIOUS ANNUAL INSPECTION?	N/A*	
	(IF YES, DESCRIBE):		
(ii)	LOCATION AND TYPE OF EXISTING INSTRUMENTATION	SEE ATTACHED PLAN	
(ii)	MAXIMUM RECORDED READING OF EACH INSTRUMENT SINCE PREVIOUS ANNUAL INSPECTION	N/A*	
(iii)	APPROXIMATE MINIMUM, MAXIMUM AND PRESENT DEPTH AND ELEVATION OF THE IMPOUNDED WATER SINCE PREVIOUS ANNUAL INSPECTION (ft)		
	MIN. DEPTH: N/A*	MAX. DEPTH: N/A*	PRESENT DEPTH: 19.5
	MIN. ELEVATION: N/A*	MAX. ELEVATION: N/A*	PRESENT. ELEVATION: 59.0
(iii)	APPROXIMATE MINIMUM, MAXIMUM AND PRESENT DEPTH AND ELEVATION OF CCR SINCE PREVIOUS ANNUAL INSPECTION. (ft)		
	MIN. DEPTH: N/A*	MAX. DEPTH: N/A*	PRESENT DEPTH: 19.5
	MIN. ELEVATION: N/A*	MAX. ELEVATION: N/A*	PRESENT ELEVATION: 59.0
(iv)	APPROXIMATE STORAGE CAPACITY OF IMPOUNDING STRUCTURE AT TIME OF INSPECTION. (yd3)	113,921**	
(v)	APPROXIMATE VOLUME OF IMPOUNDED WATER AND CCR AT TIME OF INSPECTION (yd3)	WATER: 86,420**	CCR: 26,871**
(vi)	ANY APPEARANCE OF AN ACTUAL OR POTENTIAL STRUCTURAL WEAKNESS OF THE CCR UNIT, IN ADDITION TO ANY EXISTING CONDITIONS THAT ARE DISRUPTING OR HAVE THE POTENTIAL TO DISRUPT THE OPERATION AND SAFETY OF THE CCR UNIT AND APPURTENANT STRUCTURES?	NO	
	(IF YES, DESCRIBE):		
(vii)	ANY OTHER CHANGE(S) WHICH MAY HAVE AFFECTED THE STABILITY OR OPERATION SINCE THE PREVIOUS ANNUAL INSPECTION?	N/A*	
	(IF YES, DESCRIBE):		

* This is the first 'Annual Inspection by a qualified professional engineer' performed in accordance with 40 CFS Part 257.83. This information will be included in subsequent annual inspection reports.

** Cubic yard estimates are derived by qualified personnel from available information.



257.83 (b) (2)	REPORT OF ANNUAL INSPECTION OF CCR SURFACE IMPOUNDMENT		
	FACILITY NAME: Plant McIntosh AP-1, Cell B		
	OWNER/OPERATOR OF FACILITY: Georgia Power Company		
	INSPECTION DATE: October 22, 2015		
	INSPECTING ENGINEER: Joel L. Galt, P.E. (Georgia P.E. License #014090)		
	Based on the results of my inspection and review of the data provided, it is my professional opinion that the report has been completed in accordance with 40 CFR 257.83(b).		
(i)	ANY CHANGES IN GEOMETRY OF THE IMPOUNDING STRUCTURE SINCE THE PREVIOUS ANNUAL INSPECTION?	N/A*	
	(IF YES, DESCRIBE):		
(ii)	LOCATION AND TYPE OF EXISTING INSTRUMENTATION	SEE ATTACHED PLAN	
(ii)	MAXIMUM RECORDED READING OF EACH INSTRUMENT SINCE PREVIOUS ANNUAL INSPECTION	N/A*	
(iii)	APPROXIMATE MINIMUM, MAXIMUM AND PRESENT DEPTH AND ELEVATION OF THE IMPOUNDED WATER SINCE PREVIOUS ANNUAL INSPECTION (ft)		
	MIN. DEPTH: N/A*	MAX. DEPTH: N/A*	PRESENT DEPTH: 19.2
	MIN. ELEVATION: N/A*	MAX. ELEVATION: N/A*	PRESENT. ELEVATION: 58.7
(iii)	APPROXIMATE MINIMUM, MAXIMUM AND PRESENT DEPTH AND ELEVATION OF CCR SINCE PREVIOUS ANNUAL INSPECTION (ft)		
	MIN. DEPTH: N/A*	MAX. DEPTH: N/A*	PRESENT DEPTH: 20.5
	MIN. ELEVATION: N/A*	MAX. ELEVATION: N/A*	PRESENT ELEVATION: 60.0
(iv)	APPROXIMATE STORAGE CAPACITY OF IMPOUNDING STRUCTURE AT TIME OF INSPECTION. (yd3)	136,868**	
(v)	APPROXIMATE VOLUME OF IMPOUNDED WATER AND CCR AT TIME OF INSPECTION (yd3)	WATER: 125,644**	CCR: 11,224**
(vi)	ANY APPEARANCE OF AN ACTUAL OR POTENTIAL STRUCTURAL WEAKNESS OF THE CCR UNIT, IN ADDITION TO ANY EXISTING CONDITIONS THAT ARE DISRUPTING OR HAVE THE POTENTIAL TO DISRUPT THE OPERATION AND SAFETY OF THE CCR UNIT AND APPURTENANT STRUCTURES?	NO	
	(IF YES, DESCRIBE):		
(vii)	ANY OTHER CHANGE(S) WHICH MAY HAVE AFFECTED THE STABILITY OR OPERATION SINCE THE PREVIOUS ANNUAL INSPECTION?	N/A*	
	(IF YES, DESCRIBE):		

* This is the first 'Annual Inspection by a qualified professional engineer' performed in accordance with 40 CFS Part 257.83. This information will be included in subsequent annual inspection reports.

** Cubic yard estimates are derived by qualified personnel from available information.



257.83 (b) (2)	REPORT OF ANNUAL INSPECTION OF CCR SURFACE IMPOUNDMENT		
	FACILITY NAME: Plant McIntosh AP-1, Cell C		
	OWNER/OPERATOR OF FACILITY: Georgia Power Company		
	INSPECTION DATE: October 22, 2015		
	INSPECTING ENGINEER: Joel L. Galt, P.E. (Georgia P.E. License #014090)		
	Based on the results of my inspection and review of the data provided, it is my professional opinion that the report has been completed in accordance with 40 CFR 257.83(b).		
(i)	ANY CHANGES IN GEOMETRY OF THE IMPOUNDING STRUCTURE SINCE THE PREVIOUS ANNUAL INSPECTION?	N/A*	
	(IF YES, DESCRIBE):		
(ii)	LOCATION AND TYPE OF EXISTING INSTRUMENTATION	SEE ATTACHED PLAN	
(ii)	MAXIMUM RECORDED READING OF EACH INSTRUMENT SINCE PREVIOUS ANNUAL INSPECTION	N/A*	
(iii)	APPROXIMATE MINIMUM, MAXIMUM AND PRESENT DEPTH AND ELEVATION OF THE IMPOUNDED WATER SINCE PREVIOUS ANNUAL INSPECTION (ft)		
	MIN. DEPTH: N/A*	MAX. DEPTH: N/A*	PRESENT DEPTH: 19.5
	MIN. ELEVATION: N/A*	MAX. ELEVATION: N/A*	PRESENT. ELEVATION: 59.0
(iii)	APPROXIMATE MINIMUM, MAXIMUM AND PRESENT DEPTH AND ELEVATION OF CCR SINCE PREVIOUS ANNUAL INSPECTION. (ft)		
	MIN. DEPTH: N/A*	MAX. DEPTH: N/A*	PRESENT DEPTH: 0.0
	MIN. ELEVATION: N/A*	MAX. ELEVATION: N/A*	PRESENT ELEVATION: N/A
(iv)	APPROXIMATE STORAGE CAPACITY OF IMPOUNDING STRUCTURE AT TIME OF INSPECTION. (yd3)	131,049**	
(v)	APPROXIMATE VOLUME OF IMPOUNDED WATER AND CCR AT TIME OF INSPECTION (yd3)	WATER: 131,049**	CCR: 0**
(vi)	ANY APPEARANCE OF AN ACTUAL OR POTENTIAL STRUCTURAL WEAKNESS OF THE CCR UNIT, IN ADDITION TO ANY EXISTING CONDITIONS THAT ARE DISRUPTING OR HAVE THE POTENTIAL TO DISRUPT THE OPERATION AND SAFETY OF THE CCR UNIT AND APPURTENANT STRUCTURES?	NO	
	(IF YES, DESCRIBE):		
(vii)	ANY OTHER CHANGE(S) WHICH MAY HAVE AFFECTED THE STABILITY OR OPERATION SINCE THE PREVIOUS ANNUAL INSPECTION?	N/A*	
	(IF YES, DESCRIBE):		

* This is the first 'Annual Inspection by a qualified professional engineer' performed in accordance with 40 CFS Part 257.83. This information will be included in subsequent annual inspection reports.

** Cubic yard estimates are derived by qualified personnel from available information.



257.83 (b) (2)	REPORT OF ANNUAL INSPECTION OF CCR SURFACE IMPOUNDMENT		
	FACILITY NAME: Plant McIntosh AP-1, Cell D		
	OWNER/OPERATOR OF FACILITY: Georgia Power Company		
	INSPECTION DATE: October 22, 2015		
	INSPECTING ENGINEER: Joel L. Galt, P.E. (Georgia P.E. License #014090)		
	Based on the results of my inspection and review of the data provided, it is my professional opinion that the report has been completed in accordance with 40 CFR 257.83(b).		
(i)	ANY CHANGES IN GEOMETRY OF THE IMPOUNDING STRUCTURE SINCE THE PREVIOUS ANNUAL INSPECTION?	N/A*	
	(IF YES, DESCRIBE):		
(ii)	LOCATION AND TYPE OF EXISTING INSTRUMENTATION	SEE ATTACHED PLAN	
(ii)	MAXIMUM RECORDED READING OF EACH INSTRUMENT SINCE PREVIOUS ANNUAL INSPECTION	N/A*	
(iii)	APPROXIMATE MINIMUM, MAXIMUM AND PRESENT DEPTH AND ELEVATION OF THE IMPOUNDED WATER SINCE PREVIOUS ANNUAL INSPECTION (ft)		
	MIN. DEPTH: N/A*	MAX. DEPTH: N/A*	PRESENT DEPTH: 21.05
	MIN. ELEVATION: N/A*	MAX. ELEVATION: N/A*	PRESENT. ELEVATION: 59.0
(iii)	APPROXIMATE MINIMUM, MAXIMUM AND PRESENT DEPTH AND ELEVATION OF CCR SINCE PREVIOUS ANNUAL INSPECTION. (ft)		
	MIN. DEPTH: N/A*	MAX. DEPTH: N/A*	PRESENT DEPTH: 1.6 (estimated)
	MIN. ELEVATION: N/A*	MAX. ELEVATION: N/A*	PRESENT ELEVATION: 41.1 (estimated)
(iv)	APPROXIMATE STORAGE CAPACITY OF IMPOUNDING STRUCTURE AT TIME OF INSPECTION. (yd3)	31,924**	
(v)	APPROXIMATE VOLUME OF IMPOUNDED WATER AND CCR AT TIME OF INSPECTION (yd3)	WATER: 28,658**	CCR: 3,266**
(vi)	ANY APPEARANCE OF AN ACTUAL OR POTENTIAL STRUCTURAL WEAKNESS OF THE CCR UNIT, IN ADDITION TO ANY EXISTING CONDITIONS THAT ARE DISRUPTING OR HAVE THE POTENTIAL TO DISRUPT THE OPERATION AND SAFETY OF THE CCR UNIT AND APPURTENANT STRUCTURES?	NO	
	(IF YES, DESCRIBE):		
(vii)	ANY OTHER CHANGE(S) WHICH MAY HAVE AFFECTED THE STABILITY OR OPERATION SINCE THE PREVIOUS ANNUAL INSPECTION?	N/A*	
	(IF YES, DESCRIBE):		

* This is the first 'Annual Inspection by a qualified professional engineer' performed in accordance with 40 CFS Part 257.83. This information will be included in subsequent annual inspection reports.

** Cubic yard estimates are derived by qualified personnel from available information.



GRID NORTH
 GEORGIA STATE PLANE - WEST ZONE (NAD83/94)

LATITUDE: N32°00'06"
 LONGITUDE: W81°14'41"

- UTILITY LEGEND**
- ⊕ Electric Manhole
 - ⊕ Electric Meter
 - ⊕ Gas Manhole
 - ⊕ Gas Valve
 - ⊕ Gas Meter
 - ⊕ Sanitary Sewer Manhole
 - ⊕ Sanitary Sewer Cleanout
 - ⊕ Storm Sewer Manhole
 - ⊕ Telephone Manhole
 - ⊕ Water Manhole
 - ⊕ Water Valve
 - ⊕ Water Meter
 - ⊕ Fire Hydrant
 - ⊕ Well
 - ⊕ Power Pole
 - ⊕ Transmission Tower
 - ⊕ Guy Wire

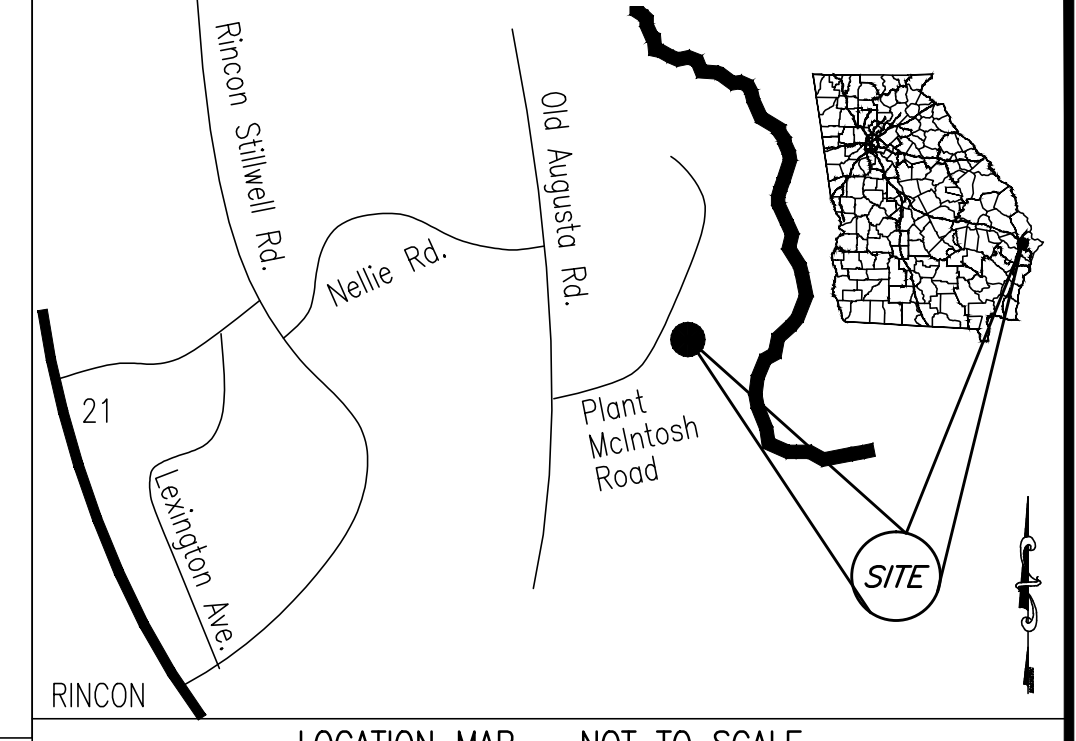

- PLAT ABBREVIATIONS**
- IPF - Iron Pin Found
 - IPS - Iron Pin Set
 - FPS - Fence Post Set
 - OTP - Open Top Pipe
 - CTP - Crimp Top Pipe
 - Conc. - Concrete
 - Alum. - Aluminum
 - P/L - Property Line
 - R/W - Right of Way
 - C/L - Centerline
 - F/L - Fenceline
 - T/L - Transmission Line
 - N/F - Now or Formerly
 - DB - Deed Book
 - PB - Plat Book
 - MF - Map File No.
 - N.T.S. - Not to Scale
 - P.O.C. - Point of Commencement
 - P.O.B. - Point of Beginning
 - ⊕BH - Geotechnical Bore Hole
 - UGP - Underground Power
 - OHU - Overhead Utilities
 - GPC - Georgia Power Company
- MONUMENTATION LEGEND**
- ⊕ Iron Pin Set
 - ⊕ Iron Pin Found
 - ⊕ Monument Set
 - ⊕ Monument Found
 - ⊕ Computed Point
 - ⊕ Control or Traverse Point
 - ⊕ Geodetic Control Point
 - ⊕ Benchmark or Temporary Benchmark (TBM)

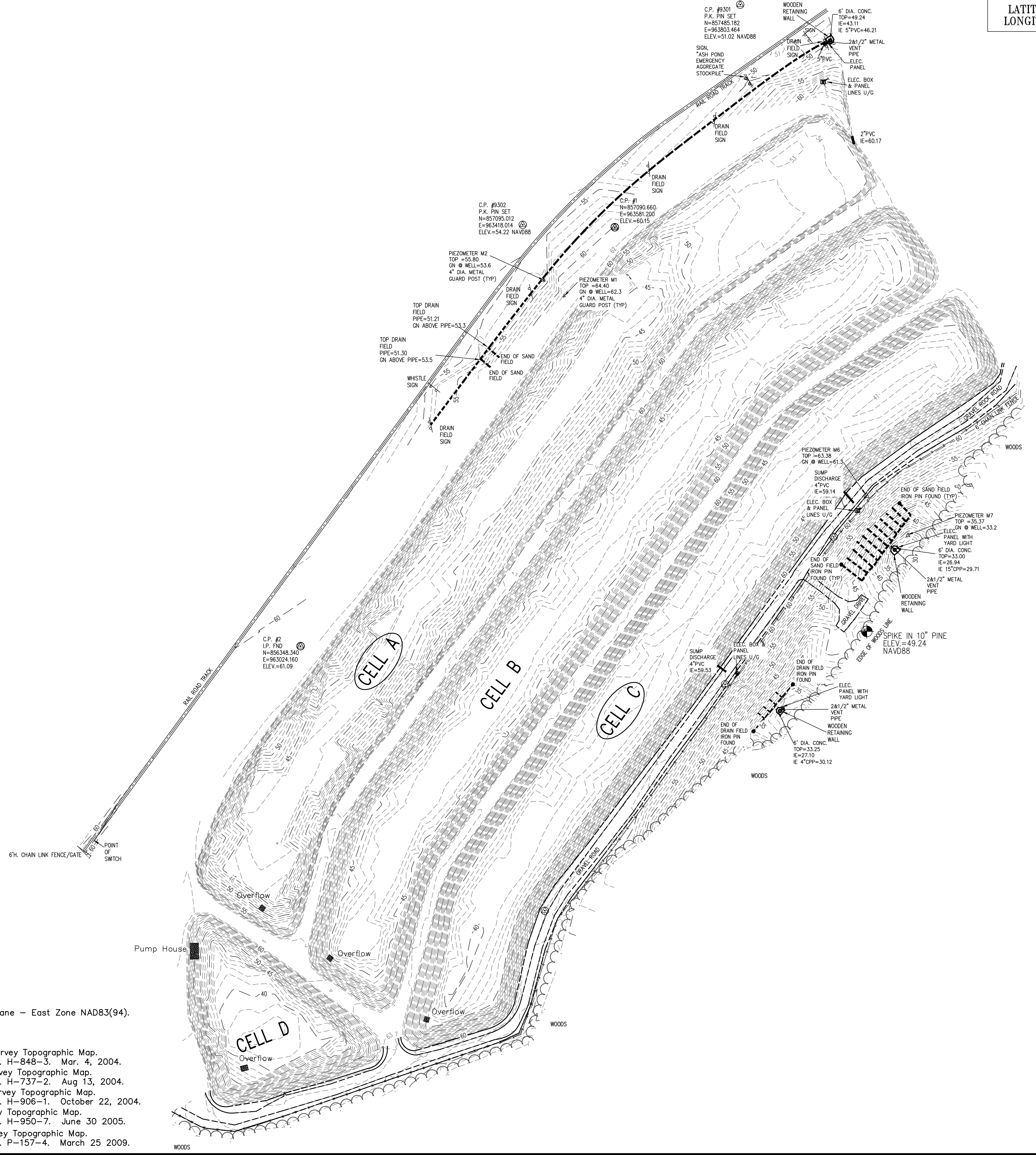

- Notes:**
- All coordinates shown are in Georgia State Plane - East Zone NAD83(94).
- References**
- Plant McIntosh Ash Cells - February 2004 Survey Topographic Map. GPC Land Dept. records center, map file no. H-848-3. Mar. 4, 2004.
 - Plant McIntosh Ash Cells - August 2004 Survey Topographic Map. GPC Land Dept. records center, map file no. H-737-2. Aug 13, 2004.
 - Plant McIntosh Ash Cells - October 2004 Survey Topographic Map. GPC Land Dept. records center, map file no. H-906-1. October 22, 2004.
 - Plant McIntosh Ash Cells - June 2005 Survey Topographic Map. GPC Land Dept. records center, map file no. H-950-7. June 30 2005.
 - Plant McIntosh Ash Cells - March 2009 Survey Topographic Map. GPC Land Dept. records center, map file no. P-157-4. March 25 2009.

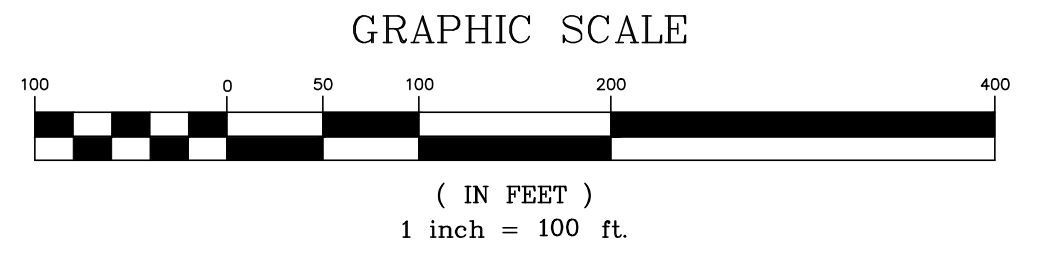

PATH - T:\working2\Plants\McIntosh\20110105_Plant McIntosh C Pond\working dwgs\
 DEED FILE - [deed file no.] LETTER FILE - [letter file no.]

GEORGIA POWER CO., ATLANTA, GA.
Land Department

PLANT McINTOSH "A" AND "C" ASH CELL PONDS
SUBSURFACE DRAINS
TOPOGRAPHIC PARTIAL AS-BUILT
 G.M.D. 9, EFFINGHAM COUNTY, GEORGIA

APPROVALS	DR.	TR.	Checked
	LAC		
REVISION BLOCK	SCALE	DATE	
	1" = 100'	04/18/2011	
5/23/2011 CHANGED LINE SPACING IN TEXT	DRAWING NUMBER	SHEET	
	P-249-1	1 of 2	